

INSTRUCTIONS AND MAINTENANCE

SERIES MINI 1

STEAM GENERATOR
WITH IRON

A step ahead



ROTONDI[®] group

DECLARATION OF CONFORMITY No.

This declaration refers to:



Name of the manufacturer: **ROTONDI GROUP SRL**

Manufacturer's address: **VIA FRATELLI ROSSELLI 14/16 – 20019 SETTIMO MILANESE**

Description of the material:

Model and Type: **MINI STEAM GENERATOR WITH IRON**

Serial number: **SERIES MINI 1**

Client:

User:

Order:

Year of manufacture:

The **ROTONDI GROUP s.r.l.** this signatory , declares under its own responsibility that the machinery covered by this declaration is complies with the requirements of the applicable EC directives:

- LVD Low voltage directive: 2014/35/EU
- EN 60335-2-3:2016 in conjunction with
- EN 60335-1:2012 +AC:2014 + A11:2014

and that is the technical construction file was drafted serie **MINI 1 REV. 2020 _ivi** expected.

Settimo Milanese, date of:

TECHNICAL MANAGER:
DAVIDE ROTONDI

INSTRUCTIONS AND MAINTENANCE MOD. MINI 1



Read these directions carefully before operating.
Don't use the machine differently from the following description.

1. SPECIFICATIONS

MODEL:	MINI 1
POWER SUPPLY:	230 V / Hz 50-60
TOTAL INSTALLED POWER:	W 1950
IRON POWER:	W 800
BOILER POWER:	W 1150
BOILER NET CAPACITY:	L. 0,8
BOILER CAPACITY:	L. 1,2
IRONING ENDURANCE:	about 1 hours
OPERATING STEAM	2,5 BAR
MAXIMUM PRESSURE:	5 BAR
WEIGHT:	KG. 6,5
OVERALL DIMENSIONS:	cm 20x30x19 h.
MADE IN ITALY	

2. IMPORTANT

Before installing MINI 1, it is necessary to set up the following facilities:

1. electrical plug protected and suitable to MINI 1 power (it is better to use an earth protector magnetothermic switch 16 A Id 30mA)
2. a steady and plane surface where to put the machine. For the transport and the displacement, take the generator only by the handle, never pull its electric wires.

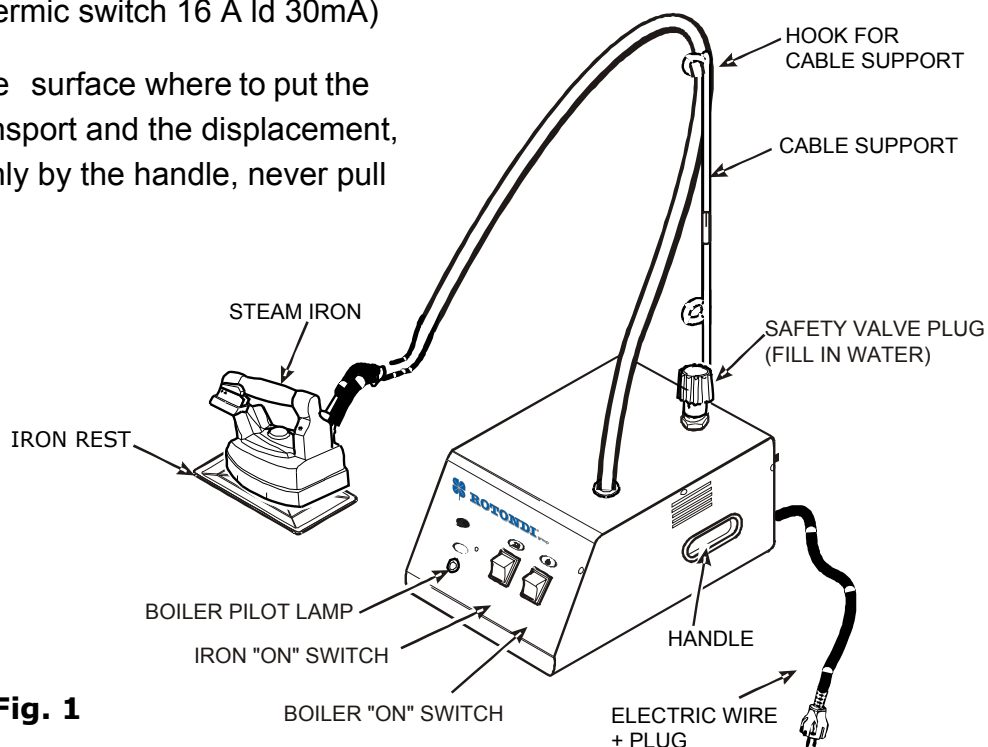

Fig. 1

3. OPENING OF PACKAGE

1. Open the box containing MINI 1, take the instructions manual and read it carefully.
2. Remove MINI 1 from the box, insert the cable support deep into the special support holder (fig. 1) placed on the back side of the generator.
3. Fix iron cable to the support hook (avoid twining).
4. Put the iron on its rubber iron rest (Fig.1).



4. CONNECTION AND STARTING

With MINI 1 switched off and disconnected plug:

1. Unscrew the security valve plug (fig. 1), fill the boiler with water till overflow or at pleasure (we advise you to use a funnel). Take the plug by the plastic part and screw it again: do not tighten too much or its gasket might get damaged. P.S. during the filling do not spill water onto outside of the machine; in the event this should happen, dry it immediately in order to avoid the risk of electrical discharges.
2. Insert the plug into a 230 V 16 A socket.
3. Switch on the boiler (fig. 1), the iron (fig. 1) and adjust the thermostat (fig. 2) on "cotton".
4. Wait for the boiler lamp to switch off. At this point seize the iron by cork handle and press red button 3 or 4 times (fig.1), so that steam comes out: this operation must be carried out in order to heat up the tubes which take steam to iron. In this way you prevent also the falling of small drops of water on garments. After this procedure has been done, the iron is ready. During ironing operation, the boiler lamp switches continuously on and off.



5. COMPULSORY

1. Use only normal water coming from the aqueduct.
2. Never add additives to water.
3. Empty the boiler only when it is switched off and cold (with no pressure).
For carrying out this operation, wear gloves against possible burns.
4. **Never replace the security valve plug (fig.1 with other types of plug. P.S. the security valve plug is set on 4,5 BAR and it has the function of a security valve.**



5. Connect MINI 1 to suitable protected socket.
6. Always keep children away from MINI 1, both when it is on and off.
7. Do not iron garments directly on persons or things.
8. Do not empty the boiler during the ironing operation, wait at least 1 hour after the switching off.
9. Do not leave hot iron on garments or on the board.
10. ATTENTION: don't move MINI 1 when switched on. You must move MINI 1 by the handle when is cold.



5. IRONING OPERATION

1. Run the iron on garments, pressing the iron microswitch (fig. 3) for steam. For a better result, set the thermostat (fig. 2) on "cotton".
2. For delicate, blue and black garments, we advise you to use the anti-shine shoe (3002002)
3. During ironing operation, always put the iron on its rubber rest (fig. 1) and pay attention to the position of the wires: if they twine or get in touch with ironing board, they might cause short circuits.
4. For dry ironing it is possible to adjust the thermostat (fig. 2) on different positions according to the type of fabric (look at garment label). For steam ironing set the thermostat on "cotton" or "linen".
5. If you work on a non-vacuum board, some circular water spots might form because of condensed steam. To get round this problem, put a felt under the usual padding and adjust the hand-wheel for steam regulation on minimum (fig. 2).

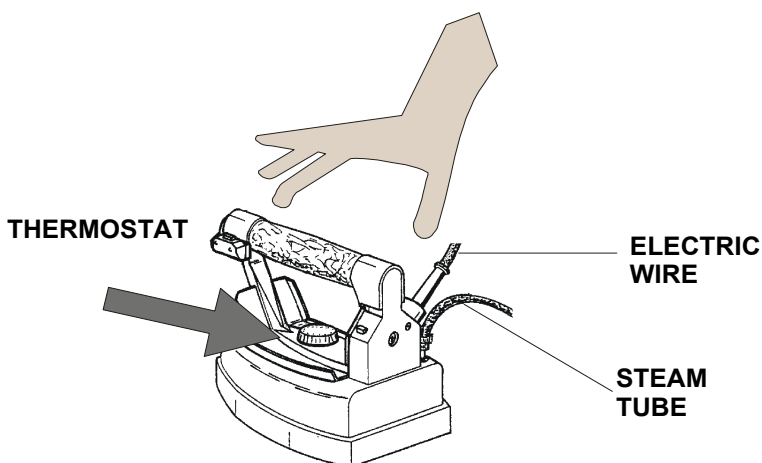

Fig. 2

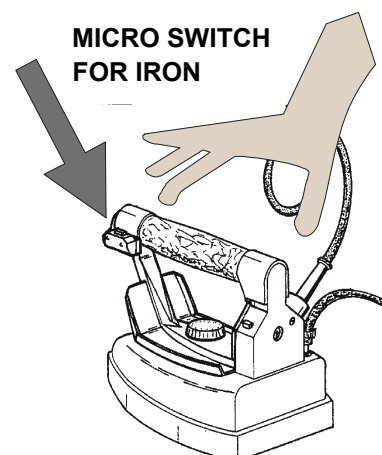

Fig. 3

6. WATER FILLING

During the ironing, if steam flow decreases considerably and then ends definitely, it means that there is no more water in the boiler. So MINI 1 has to be switched off by disconnecting the plug; rotate the valve plug (fig. 1) of 360° and wait for steam to go out completely. Unscrew the valve plug with care and wait some minutes. Then fill the boiler with water (fig.1) max 0,8 L. Screw the valve plug again, connect the plug and wait for the boiler lamp to switch off (fig. 2 C). Now the iron is ready again. **ATTENTION:** MINI 1 must always be on horizontal position.



8. BOILER DISCHARGE

Carry out this operation when the machine is off and the plug disconnected: unscrew the valve plug and rotate MINI 1 rightwards so that water and possible impurities come out.



9. GOOD FUNCTIONING

MINI 1 was designed for the ironing of domestic garments and tailor shop. It can be used maximum 8 hrs. per week or 32 hrs. per month (subdivided in many times).

10. INTERVENTIONS AND SMALL REPAIRS

1. Empty the boiler every 20 hrs. of ironing.
2. Replace the gasket of security valve plug (use only original gaskets) every 1200 hrs. of lighting or maximum 2 years. For carrying out this operation, the machine has to be switched off and cold.
3. Replace the security valve plug every 1500 hrs. of working or maximum 3 years (fig. 1). For carrying out this operation, the machine has to be switched off and cold.

11. COMPULSORY PERIODICAL MAINTENANCE

(To be carried out exclusively by Assistance Centres or by the Manufacturer)

It is needed to replace:

1. the internal security valve every 1400 hrs. of ironing or maximum 3 years;
2. the internal thermostat every 1400 hrs. of ironing or maximum 3 years;
3. steam tube and iron cable once they seem spoilt (fig. 2).

It is recommended also to clean the boiler from limestone every 1400 hrs. of ironing or maximum 3 years.

12. ELECTRICAL RISKS

The following situations are considered dangerous for the operator:

1. earth protector switch is activated when turning on the main switch,
2. using MINI 1 during thunderstorms,
3. when using MINI 1 without shoes or with improper shoes or with wet feet
4. damage of iron cables,
5. leaking of water from iron,
6. iron overheating
7. if washing or cleaning the iron with iron
8. when filling MINI 1 with water is switch on
9. if MINI 1 is leaking water



13. MECHANICAL RISKS

The following situations are considered dangerous for the operator:

1. using MINI 1 for different purposes other than ironing,
2. replacing the valve plug gasket with non-original gaskets.



14. THERMIC RISKS

The following situations are considered dangerous for the operator:

1. touching iron base when working,
2. touching the solenoid valve when the machine is under pressure
3. touching the valve plug when the machine is under pressure,
4. opening the valve plug when the machine is under pressure,
5. directing steam towards persons or animals.

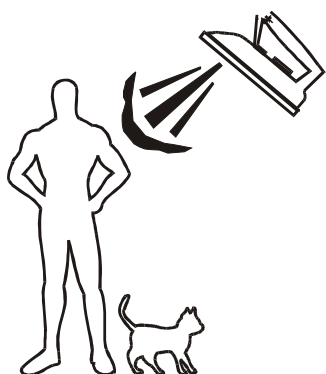

ATTENTION:
THERMIC
DANGER
INCANDESCENT
IRON BASE

- ☐ **Do not iron garments directly on persons.**
- ☐ **Do not leave hot iron on garments.**
- ☐ **After use, always put iron on its iron rest.**

15. PACKING, STORAGE AND TRANSPORT

MINI 1 can be packed with cellophane, on pallet or in cardboard box (never turn it upside down!). It is not a stiff package, therefore it is not shock-resistant. We advise you to handle the box with maximum care. Do not use it as stool or support. MINI 1 cannot be piled one on top of another (HANDLE WITH CARE).

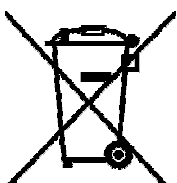
16. WASTE

Information for the correct disposal in accordance with EC directives 2002/96/EC and 2003/108/EC.

MINI 1 is mainly made of iron material and must therefore not be disposed of as urban waste but in proper waste collection centres. The crossed dustbin symbol indicates that the product must be disposed of separately from other refuse in order to avoid negative consequences for the environment and health.

PLS. follow your local laws about disposal.

17. GUARANTEE CONDITIONS

The manufacturer guarantee is no more valid when:

- the machine is tampered or repaired by non-authorized personnel,
- there is total or partial inobservance of this manual,
- the machine is badly maintained or wrongly assembled,
- the spare parts replaced are not original.

Every product manufactured by ROTONDI GROUP S.r.l. is subject to the following limitations:

ROTONDI GROUP S.r.l. guarantees that this machine, correctly installed and used, works accordingly to this manual of instructions. Each implicit guarantee is limited by law as from purchase date.

Declination of responsibility for consequential damages: **ROTONDI GROUP S.r.l.** will never take the responsibility for any damage (included, without any limitation, consequential damages due to loss or no profit, cutback or any other economical loss) deriving from the use of a ROTONDI GROUP machine, even in case the Company had been previously informed of such kind of possibility.











Should you need further information about this manual, please contact **ROTONDI GROUP S.r.l.** or the person who sold you the machine.

18. REFERENCE TO NORMS AND TERMINOLOGY EMPLOYED

Indications contained in the following documents were used in the compilation of the present manual:

- LVD Low voltage directive: 2014/35/EU
- EN 60335-2-3:2016 in conjunction with
- EN 60335-1:2012 +AC:2014 + A11:2014

19. REPORTS OF RESIDUAL RISKS

DESCRIPTION	SYMBOL	DESCRIPTION	SYMBOL
Obbligatorio leggere le istruzioni <i>It is obligatory to read the instruction</i>		Vietato spruzzare con acqua <i>Do not spray with water</i>	
Obbligatorio staccare la corrente <i>It is obligatory to disconnect the electricity</i>		Pericolo generico <i>Generic danger</i>	
Obbligatorio assicurarsi del collegamento a terra <i>Obligatory to make sure of the earth connection</i>		Pericolo: superficie calda - temperatura pericolosa <i>Danger: hot surface - dangerous temperature</i>	
Obbligo generico <i>Generic obligation</i>		Pericolo: elettricità <i>Danger: electrical current</i>	
Obbligatorio indossare i guanti protettivi <i>It is obligatory to wear protective gloves</i>		Pericolo: serbatoio in pressione <i>Danger: tank under pressure</i>	

See drawing representing
steam iron's spare parts

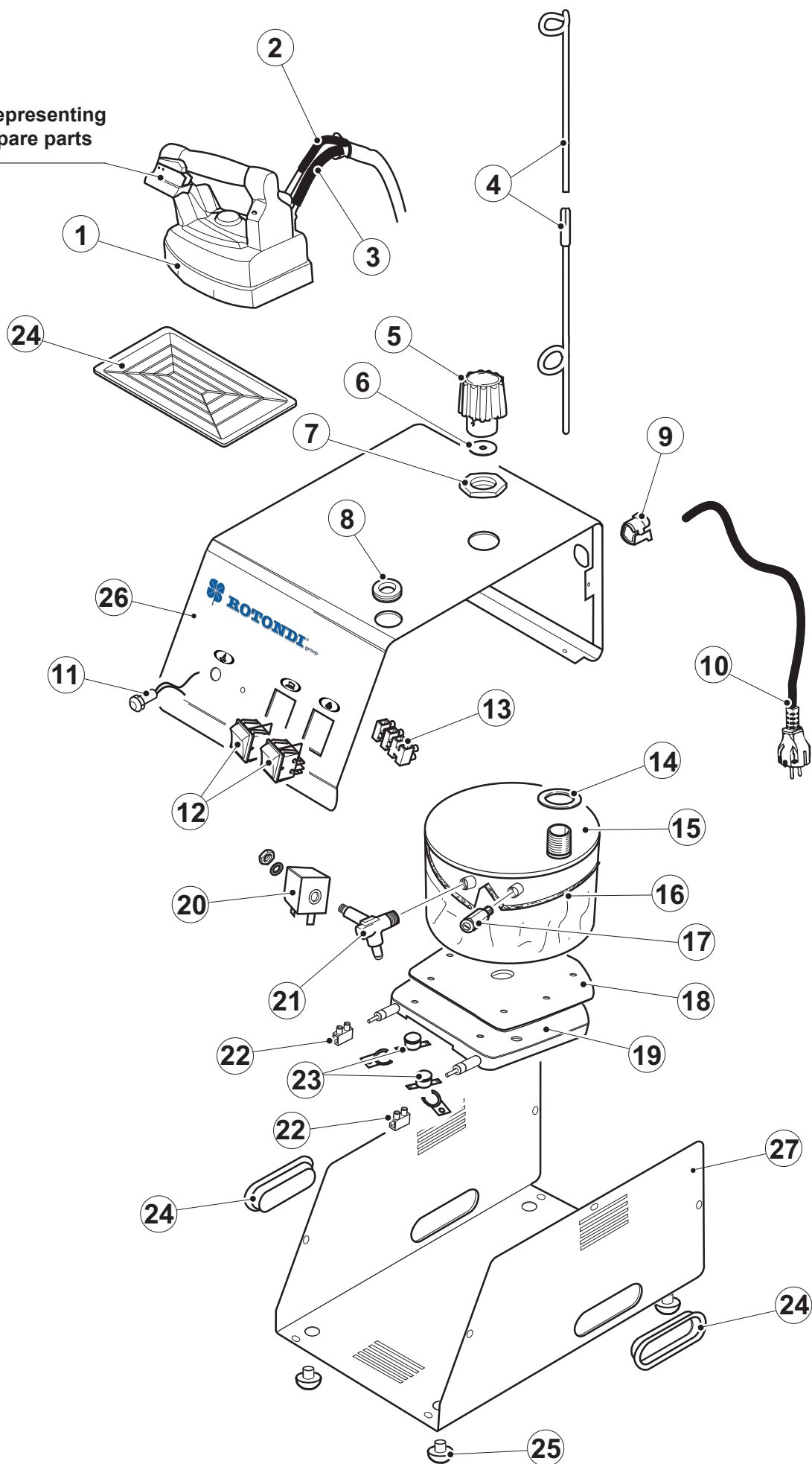

20. STEAM GENERATOR SPARE PARTS

POS.	Q.ty	DESCRIPTION	PART NUMBER
1	1	Iron	REC 100
2	1	Iron cable 4x1	3060004
3	1	Iron steam hose	3067012
4	1	Cable support	3067001
5	1	Safety cap 1/2"	3067057
6	1	Ring for cap 1/2"	3060006
7	1	Nut 1/2"	3060006/1
8	1	Rubber stopper	3067015/1
9	1	Cable holder	3067014
10	1	Electric cable	3067016
11	1	Pilot light	3067017
12	2	Switch 16A	3067018
13	1	Terminal block	3067002
14	1	Washer 1/2"	3067008/1
15	1	Boiler	3067019/1
16	1	Boiler insulation	3067020/1
17	1	Safety valve 1/8" 5 Bar	3067021
18	1	Element ring	3067022
19	1	Element 1150 W	3067023/1
20	1	Coil	3067005
21	1	Solenoid valve 1/8"	3067006/1
22	1	Terminal block	3067025
23	1	140 °C thermostat	3067024/1
24	1	Handles	3067009/1
25	2	Rubber feet	3067026
26	1	Front panel	3067013/1
27	2	Shell	3067013/1

21. IRON SPARE PARTS MOD. EC-100

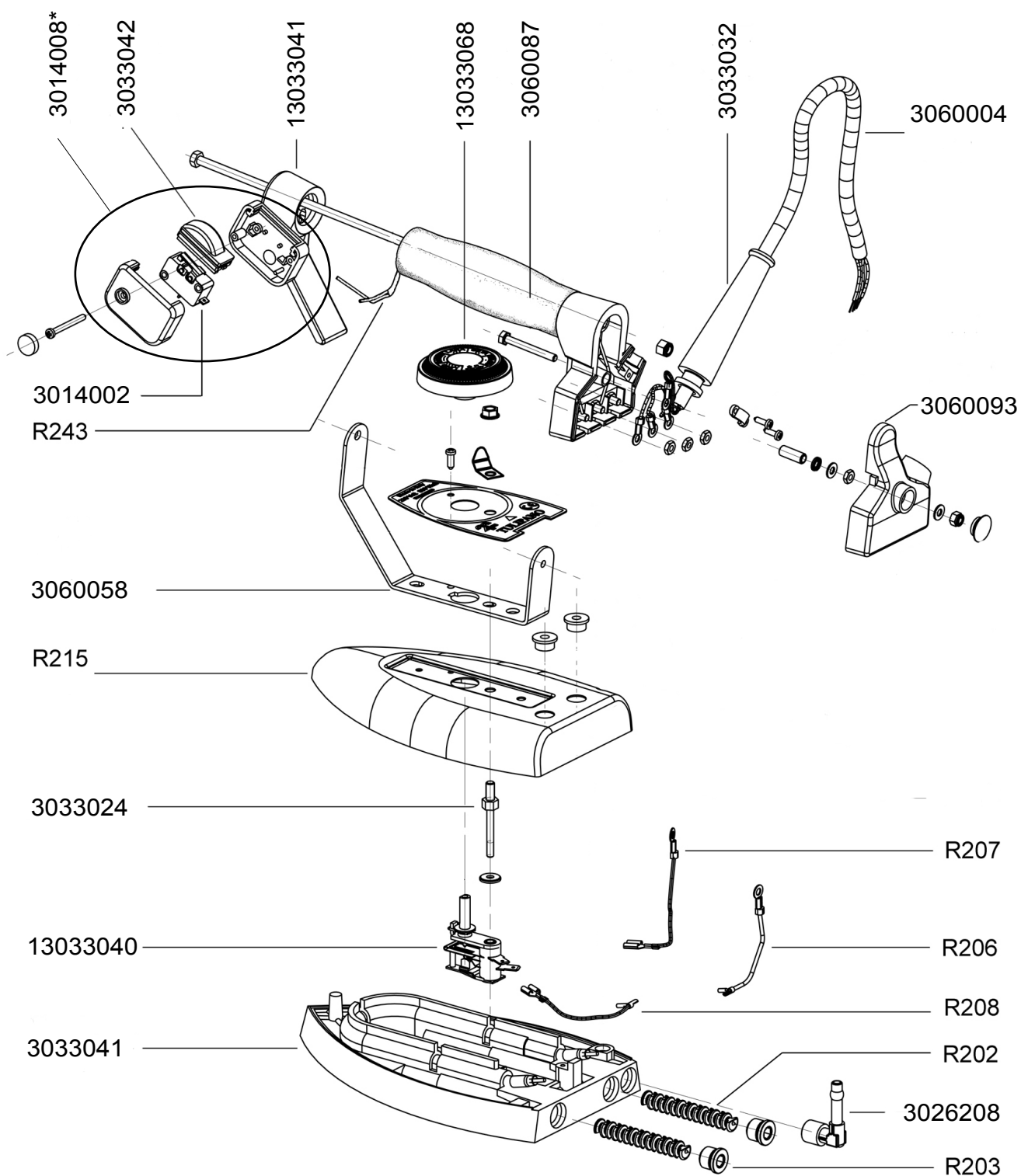

* 3014008 (VERSION 2018)

21. IRON SPARE PARTS MOD. EC-100

POS./CODE	DESCRIPTION
3033024	Spacer
3014002	Micro switch
3026208	Fitting 1/4"
3033032	Cable holder
3033041	Iron plate
3033042	Red micro cover
3060004	Cable 4 x 1
3060087	Cork handle
13033040	Termostat + thermofuse
13033068	Knob
R202	Metal filter
R203	Filter stopper
R206-207-208	Electric wires
R215	Cover
3060058	Handle support
3060093	Back handle cover
13033041	Front micro support
R243	Micro wire
*3014008	Micro switch (version 2018)

22. ACCESSORY

DESCRIPTION

Vacuum table Mod. Mini 9



Arm RA1 for vacuum table



Series Mini 3 Inox



Series Mini 4



Series Mini 5



Series Mini 5 with trolley



Via Fratelli Rosselli 14/16 - 20019 Settimo Milanese (Mi)- Italy
Tel. (+39) 02.335.01.224 - Fax (+39) 02.335.01.329
www.rotondigroup.com - Email: rotondi@rotondigroup.it